

Sbl 05

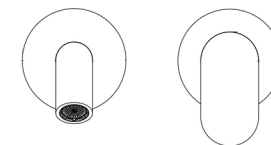

Sbl 05

Wall mounted basin mixer -33

QOOP

Stainless steel 316L



Flow rate aerator 5 l/min / 1.3 gpm, water saving



Product that needs built-in part

MAINTENANCE

DO NOT USE		cloric and muriatic acid
		hydrofluoric acid
		chlorine bleach
TO USE		neutral pH detergent



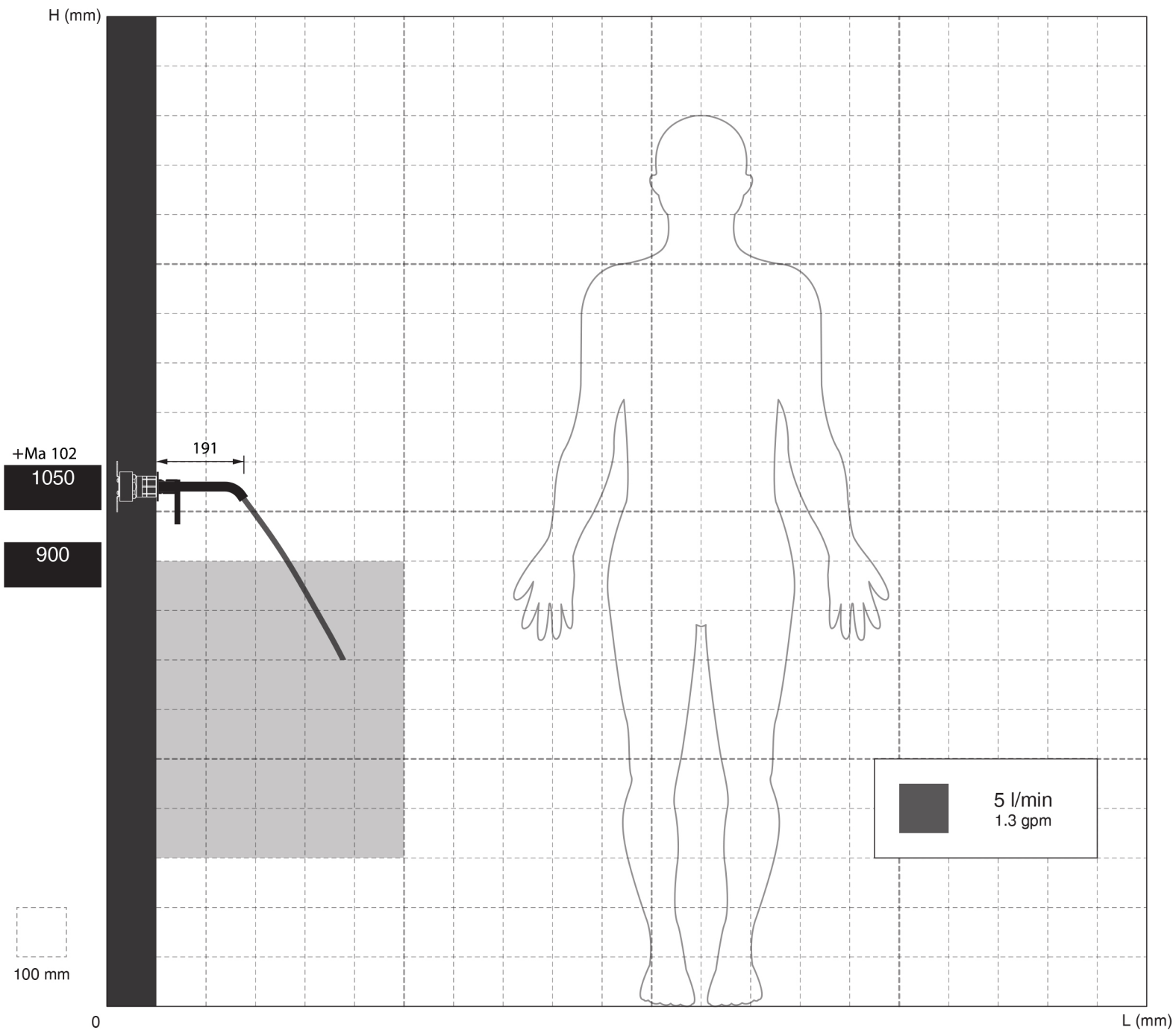

Sbl 05

INSTALLATION WARNINGS

Each individual product has to be installed and adjusted to suit the user's and the washbasin height.
The representation is purely indicative.

AERATOR INCLUDED

 **Mounted aerator**
5 l/min / 1.3 gpm

AERATORS ON DEMAND

 **Compliant with LEED standards**
1,9 l/min / 0,5 gpm

 **Compliant with LEED standards**
3,8 l/min / 1 gpm



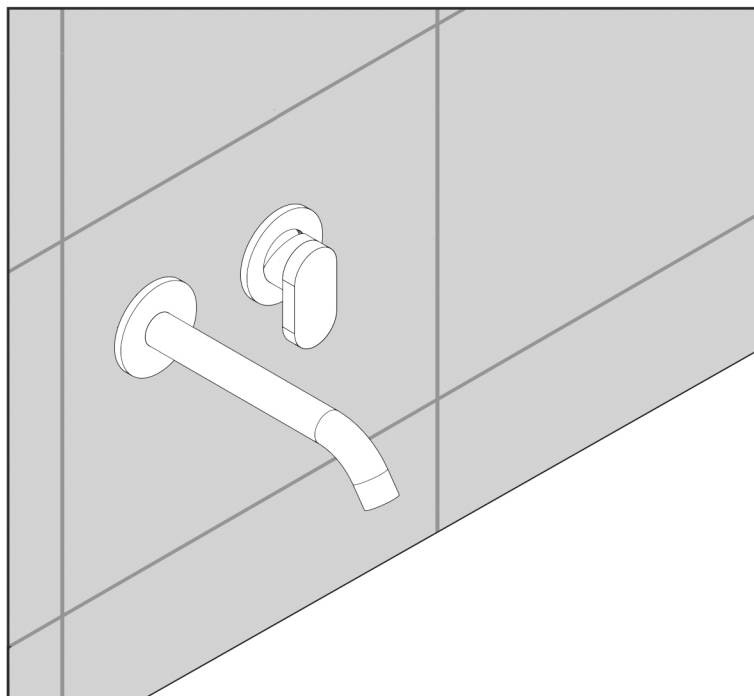
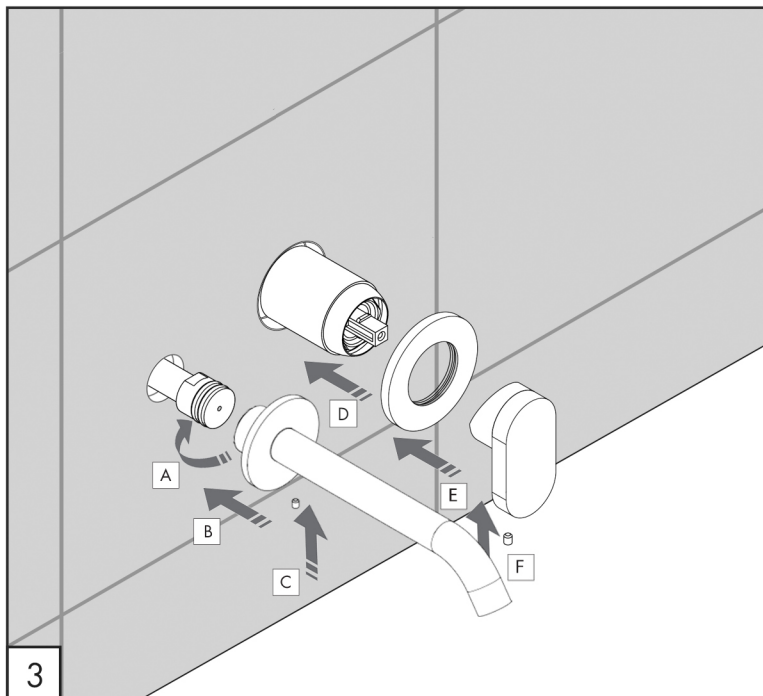
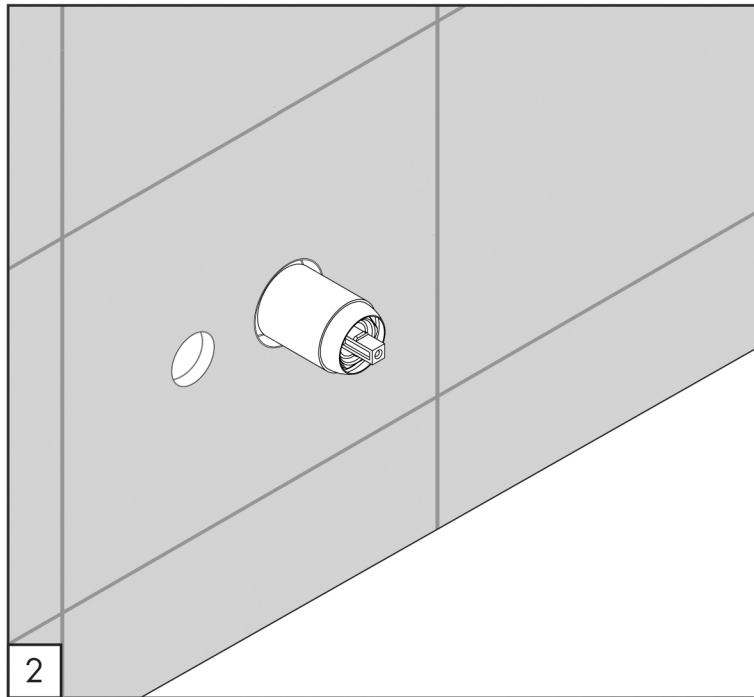
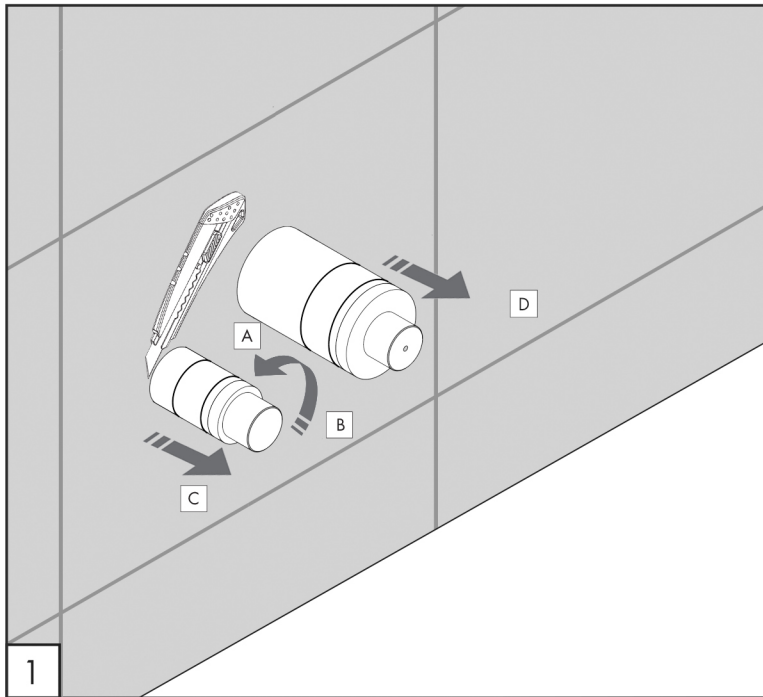

Sbl 05

TECHNICAL WARNINGS

The pipes have to be rinsed thoroughly before installation.
 Avoid pressure differences between hot and cold water supply.
 Use of a pressure reducer when static pressure is higher than 5 bar to avoid damage of the cartridge.

WORKING TEMPERATURE

 max. 70 °C
 max. 158 °F

