

# Nva 052

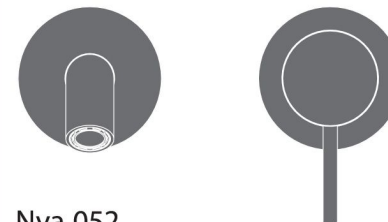

## Nva 052

Wall mounted basin mixer -33

QOOP

Stainless steel 316L



Flow rate aerator 5 l/min / 1.3 gpm, water saving



Product that needs built-in part

## MAINTENANCE

DO NOT USE		cloric and muriatic acid
		hydrofluoric acid
		chlorine bleach
TO USE		neutral pH detergent

\*ALL DIMS TO BE IN MM



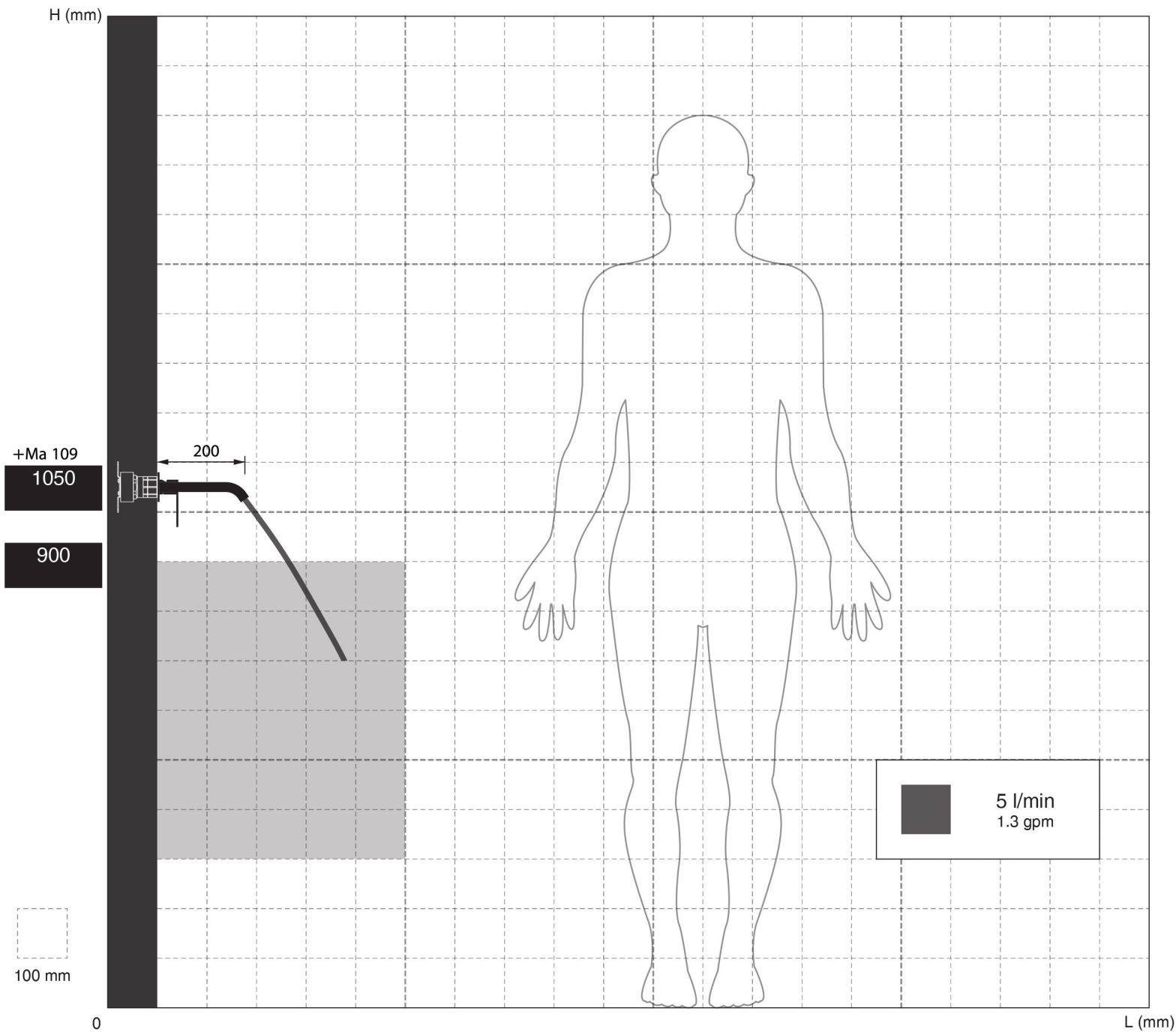

# Nva 052

## INSTALLATION WARNINGS

Each individual product has to be installed and adjusted to suit the user's and the washbasin height.  
The representation is purely indicative.

## AERATOR INCLUDED

 **Mounted aerator**  
5 l/min / 1.3 gpm

## AERATORS ON DEMAND

 **Compliant with LEED standards**  
1,9 l/min / 0.5 gpm

 **Compliant with LEED standards**  
3,8 l/min / 1 gpm



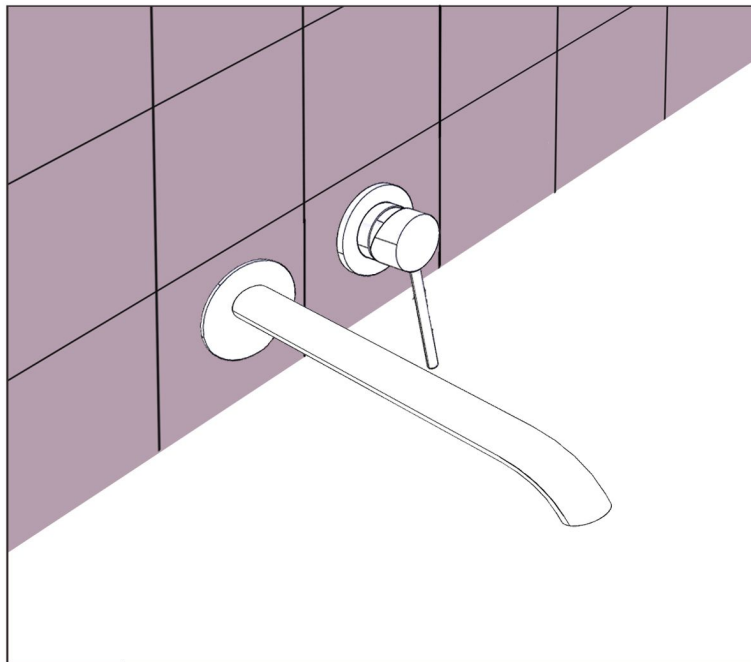
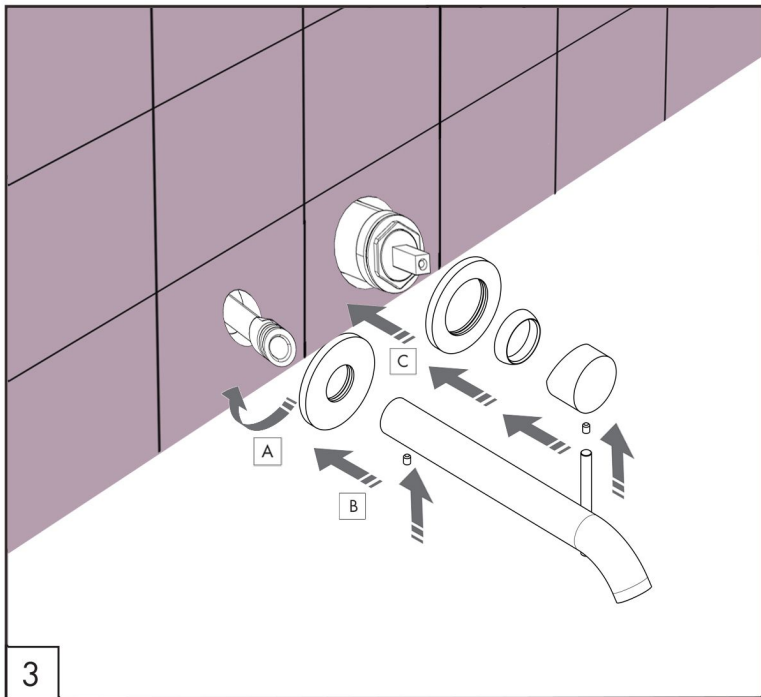
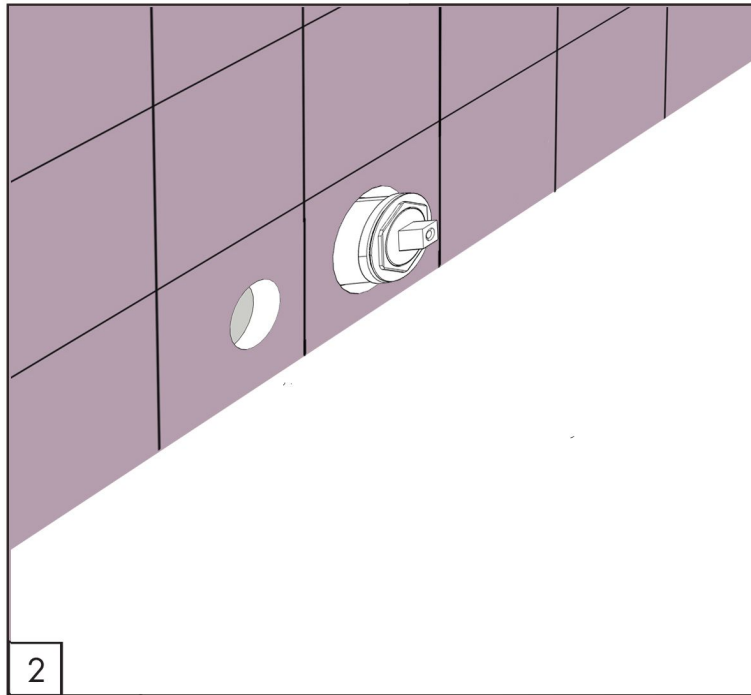
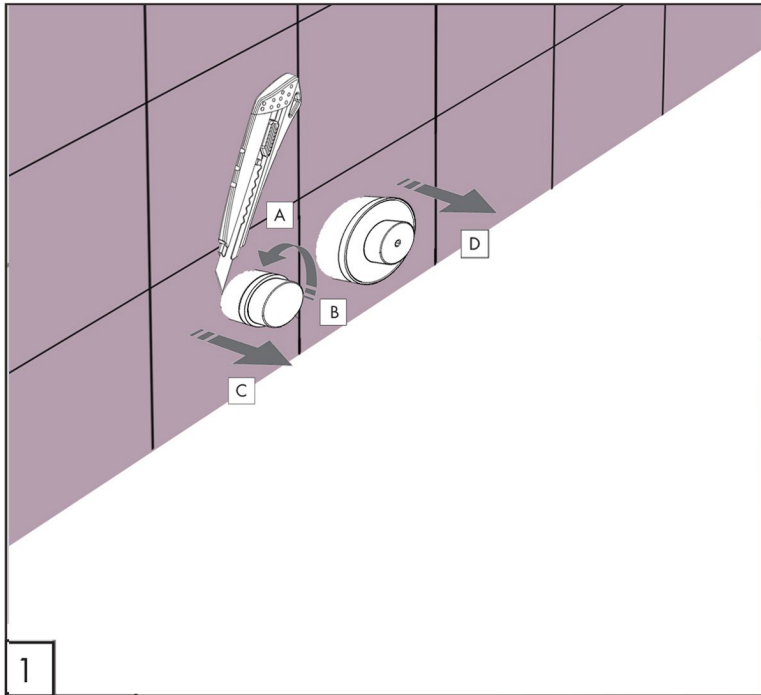

# Nva 052

## TECHNICAL WARNINGS

The pipes have to be rinsed thoroughly before installation.  
 Avoid pressure differences between hot and cold water supply.  
 Use of a pressure reducer when static pressure is higher than 5 bar to avoid damage of the cartridge.

## WORKING TEMPERATURE

 max. 70 °C  
 max. 158 °F

